



UNIVERSITY OF MINNESOTA

***MEDICAL BIOSCIENCES
BUILDING***

and

UTILITY INFRASTRUCTURE

Twin Cities Minneapolis East Bank Campus

LOCATION PLAN

Medical
Biosciences
Building

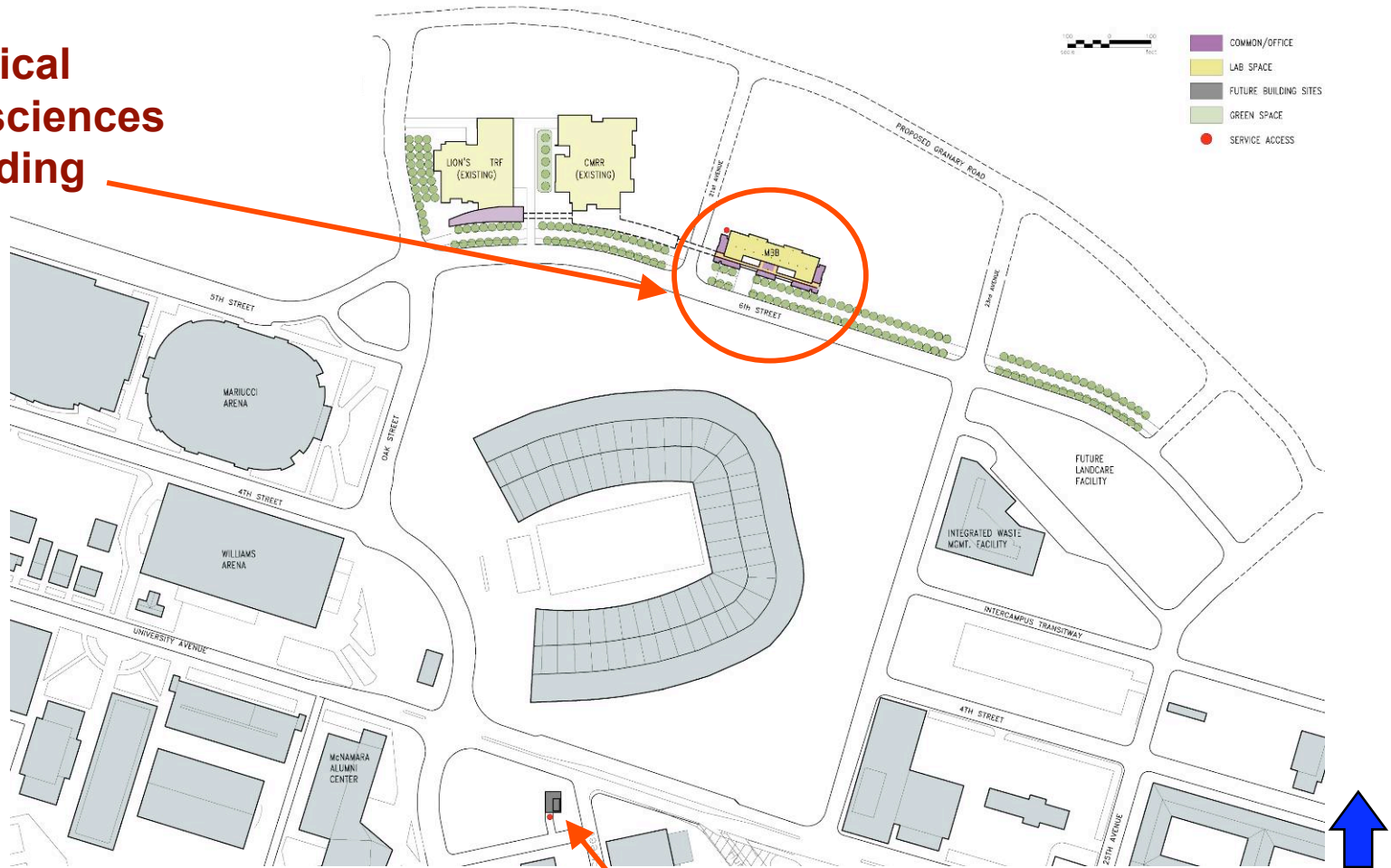

Infrastructure Building

NORTH



PROJECT RATIONALE

- Provide modern efficient laboratory research space in order to recruit and retain faculty and compete with peer institutions.
- Provide Bio-Safety Level 3 experimental laboratories in order to compete for targeted grants.
- Provide much needed expansion space for the department of Neurosciences and Immunology Center.
- Provide competitive research space for the Center for Memory Research and Care.
- Enhance the programmatic relationships between the groups currently housed in Lions, McGuire Translational Research Facility, and Center for Magnetic Resonance Research.
- Expansion of utility infrastructure to serve the development of the East Gateway District of the Minneapolis, East Bank campus.

PROJECT DESCRIPTION

- 35 Principle Investigators from the Center for Memory Research and Care (5), the Neurodegenerative Disease Group, the Neuromuscular Disease Group (15) and the Immunology Center (15).
- Space:
 - » Research Building: 68,000 assignable square feet / 111,900 gross square feet
 - » Infrastructure Building: 1,120 assignable square feet / 1,480 gross square feet
- Project Cost:

	Infrastructure	Building	Total
Construction Cost	\$8,233,000	\$47,901,000	\$56,134,000
Non Construction Cost	<u>1,704,900</u>	<u>9,661,100</u>	<u>11,366,000</u>
Total Project Cost	\$9,937,900	\$57,562,100	\$67,500,000
- Anticipated occupancy:
 - » Fall 2009
- Estimated annual operating cost:
 - » \$2,100,000 per year
- Project Team:
 - » Building Design: Perkins+Will
 - » Infrastructure: Sebesta Blomberg
 - » Construction Manager: Kraus Anderson

6th STREET EXTERIOR IMAGE



Schematic Design

March 2007

SITE PLAN



1ST FLOOR PLAN

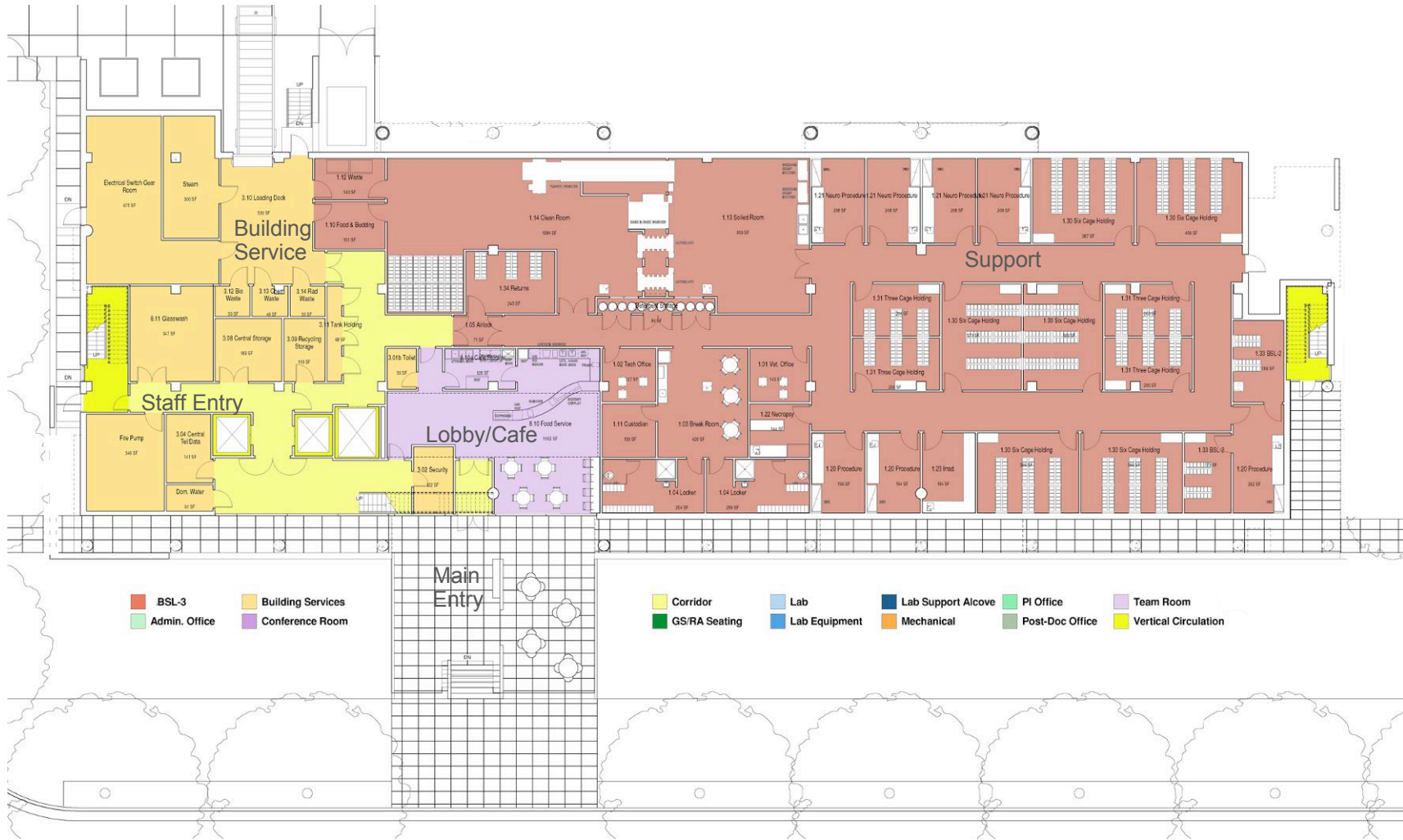

TYPICAL 2-4 FLOOR PLAN

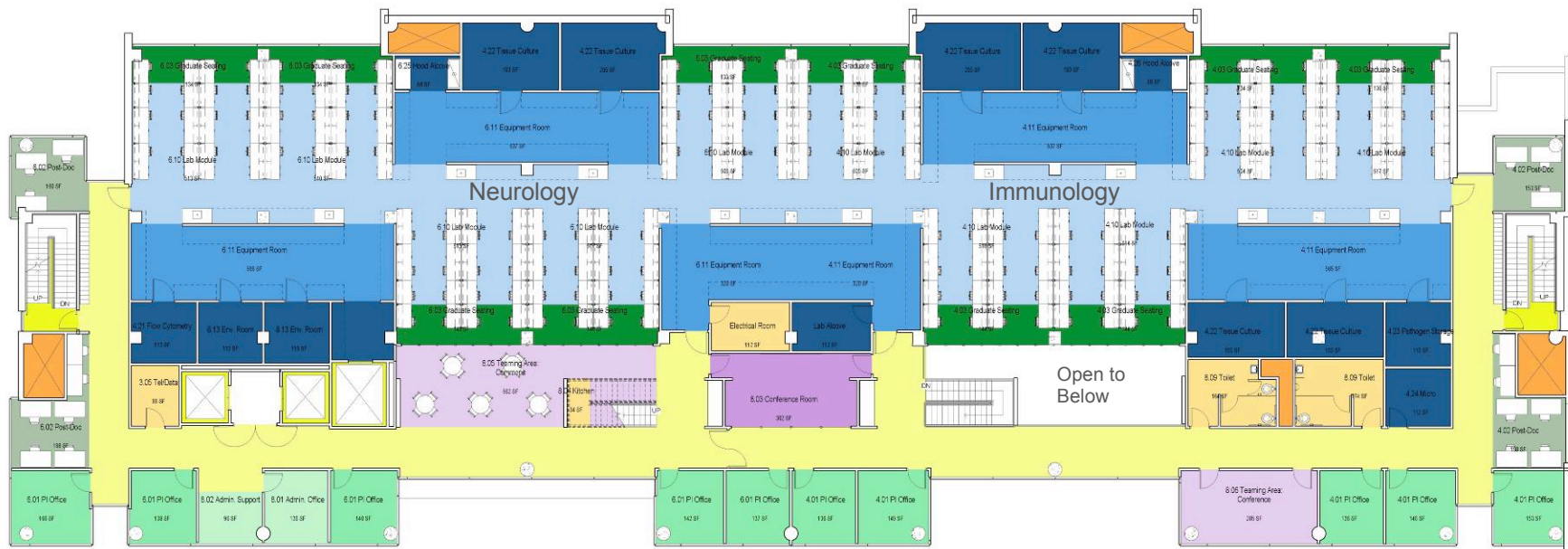

- | | | | | | | |
|--|---|--|---|--|---|--|
| ■ BSL-3 | ■ Building Services | ■ Corridor | ■ Lab | ■ Lab Support Alcove | ■ PI Office | ■ Team Room |
| ■ Admin. Office | ■ Conference Room | ■ GS/RA Seating | ■ Lab Equipment | ■ Mechanical | ■ Post-Doc Office | ■ Vertical Circulation |

TYPICAL COMMONS



FIFTH FLOOR PLAN

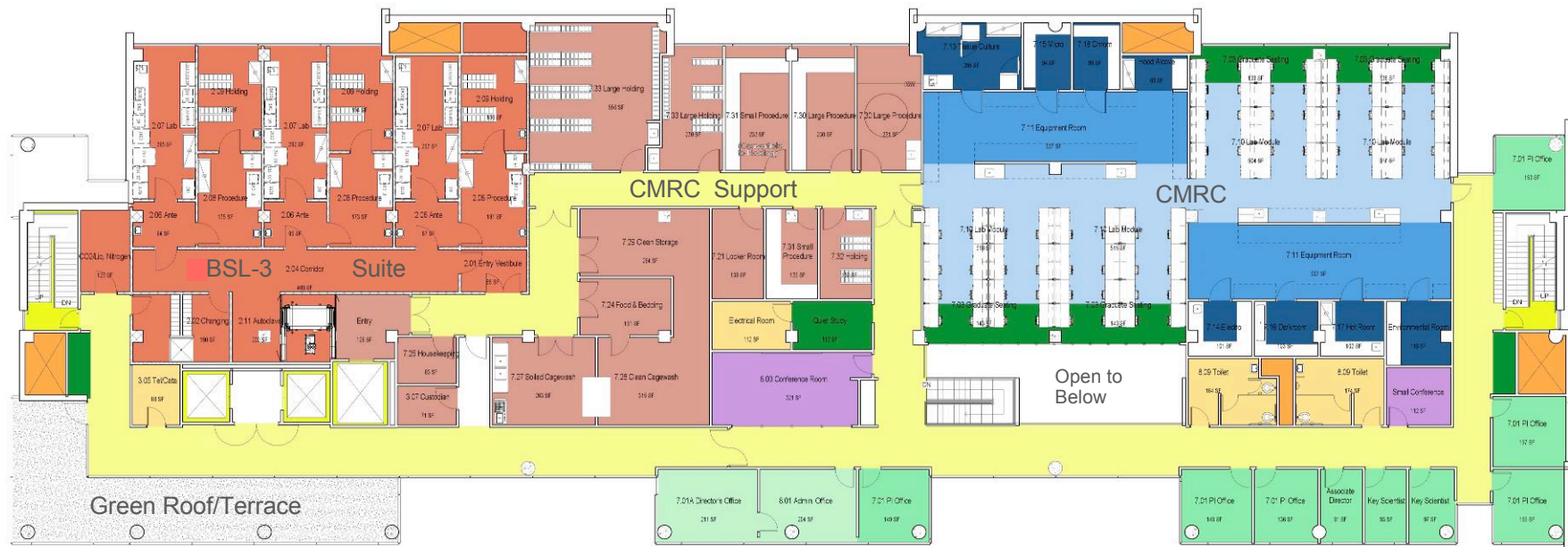

- | | | | | | | |
|---|---|---|---|--|--|--|
| BSL-3 | Building Services | Corridor | Lab | Lab Support Alcove | PI Office | Team Room |
| Admin. Office | Conference Room | GS/RA Seating | Lab Equipment | Mechanical | Post-Doc Office | Vertical Circulation |

SIXTH STREET ELEVATION



Schematic Design



March 2007

NORTH ELEVATION



Schematic Design

March 2007

21ST AVENUE EXTERIOR IMAGE



Schematic Design

March 2007

INFRASTRUCTURE PLAN

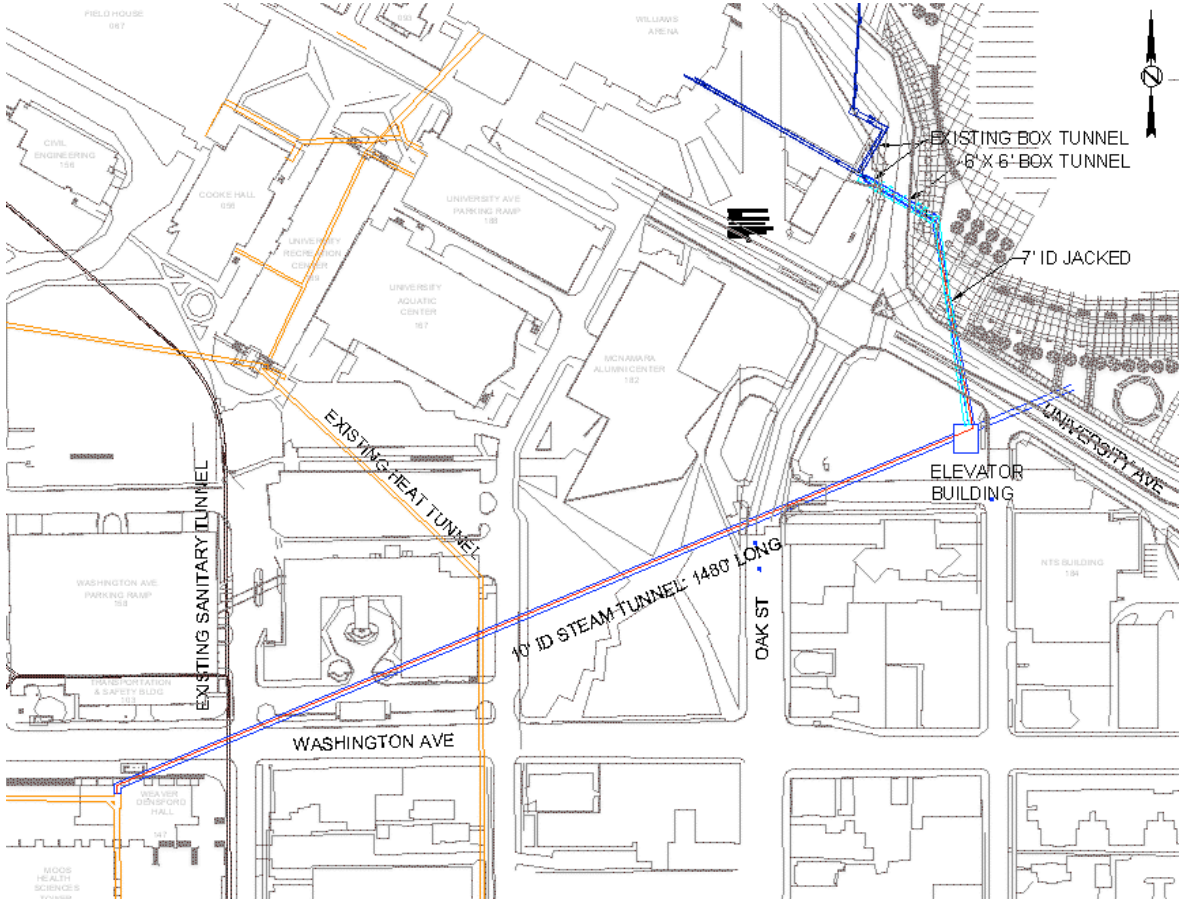

INFRASTRUCTURE BUILDING



Schematic Design

March 2007



UNIVERSITY OF MINNESOTA

***MEDICAL BIOSCIENCES
BUILDING***

and

UTILITY INFRASTRUCTURE

Twin Cities Minneapolis East Bank Campus